



PREMIUM LIST

Friday, June 12, 2026

Saturday, June 13, 2026

Sunday, June 14, 2026

107th, 108th, 109th, & 110th All-Breed
Dog Shows & Obedience Trials
43rd, 44th & 45th Rally Trials

CHERRY CAPITAL CLASSIC

NW MICHIGAN FAIRGROUNDS
TRAVERSE CITY, MICHIGAN



Premium List



GRAND TRAVERSE KENNEL CLUB

Licensed by the American Kennel Club



Cherry Capital Classic

Friday, June 12, 2026

Show 1 Conformation #2026103415¹

~ Best Veteran Competition ~

Rally Trial 1 #2026103417

Show 2 Conformation with Junior Showmanship & NOHS #2026103416¹

~ Best Bred by Exhibitor Competition ~

Rally Trial 2 #2026103418

¹Entry Limit 600

Saturday, June 13, 2026

Conformation with Junior Showmanship, NOHS & Obedience #2026103419

~ Best Puppy Competition ~

~ Best Bred by Exhibitor Competition ~

Rally Trial #2026103430

4-6 Month Beginner Puppy Competition #2026103420

Sunday, June 14, 2026

Conformation with JSHW, NOHS & Obedience #2026103421

NORTHWESTERN MICHIGAN FAIRGROUNDS

3606 Blair Townhall Road

Traverse City, MI 49685

~ Gate Pass: \$10.00 per day or \$25 for the weekend. ~

Unbenched. Show & Trial Hours: 6:00am to 5:00pm Each Day

All toy breeds will be judged indoors. All other judging will be outdoors under cover.

Conformation rings will be in one area of the fairgrounds.

Rally & Obedience trials will be inside and will run consecutively.

Parking will be available close to obedience/rally rings.



**AMERICAN
KENNEL CLUB**

CERTIFICATION Permission has been granted by the American Kennel Club for the holding of this event under the American Kennel Club rules and regulations.

SHEILA H. GOFFE, Executive Secretary

ENTRIES OPEN

12:00pm, Central Time, Saturday, April 25, 2026

Entries that are received prior to this date and time will be returned.

Entries close at 12 Noon Central Time on Wednesday, May 27, 2026 or when the numerical limit has been reached, if reached prior to this date, at **Foy Trent Dog Shows LLC in Sturgeon, MO**, after which time, entries cannot be accepted, cancelled, altered or substituted except as provided in Chapter 11, Section 6 of the Dog Show Rules.

When a dog is entered in more than one class under an event number, the highest priced class is considered the first entry.

- Please put Breed and Name of Show on Check or Money Order •

MAIL ENTRIES WITH FEES MADE OUT TO:

Foy Trent Dog Shows, PO Box C, Sturgeon, MO 65284
Entries are also accepted online at www.foytrentdogshows.com

Office Hours: Monday-Friday, 8:00am to 4:30pm Central

Entry Fees - Each Event

(See Notice to Exhibitors for AKC Fees)

CONFORMATION

First Entry of a Dog Unless Otherwise Specified	\$34.00
Each Additional Entry of the Same Dog.....	\$28.00
Puppy Classes & Bred By	\$30.00
Veteran Classes	\$27.00
Junior Showmanship (ONLY)	\$18.00
Junior Showmanship (as an additional entry)	\$12.00
4-6 Beginner Puppy Competition	\$15.00

OBEDIENCE/RALLY

First Entry of a Dog Unless Otherwise Specified	\$30.00
Each Additional Entry of the Same Dog.....	\$25.00
Optional Titling Obedience Classes	\$22.00

In Obedience and Rally Classes requiring jumps, entries **MUST** include the Dog's Jump Height
Transfers will be allowed at this trial per AKC regulations

PLEASE NOTE: Request for refunds for bitches who come in season after entries close must be made in writing, accompanied by a veterinarian's certificate, and presented to the Superintendent no later than 30 minutes prior to the start of judging.

New Exhibitor Briefing Saturday. Visit the Superintendent or Club table for details.

The AKC is committed to creating a safe and respectful sport environment for all. If you need to talk to someone, or need help, please call 800. 656.HOPE (National Sexual Assault Hotline) or text HOME to 741-741 for free, 24/7, confidential services from trained crisis counselors.



Foy Trent Dog Shows LLC

AKC Annually Licensed Superintendents:
James Davis • Ingrid Greig • Caleb O'Brien
Robert Shaffer • Foy Trent • Susan W. Trent

P.O. Box C, Sturgeon, MO 65284
(573) 687-2101 • www.foytrentdogshows.com



AKC PATCH PROGRAM



Kids of all ages are invited to join us for a fun scavenger hunt!

The Patch program helps youth learn about purebred dogs, the sport of purebred dogs, and responsible dog ownership.

After completing the activity, participants earn a patch.

June 12-13, 2026

at the Cherry Capital Classic Dog Show
Northwestern Michigan Fairgrounds
3806 Blair Town Hall Road, Traverse City, MI

Veterinarian On Call with 24 Hour Service

BAY AREA ANIMAL HOSPITAL

844 East Front Street, Traverse City, MI 49686
231-922-0911

Exhibitors should follow their veterinarian's recommendation to assure their dogs are free of internal and external parasites, any communicable diseases, and have appropriate vaccinations.

AED (Automated External Defibrillator)

is located on the Exterior Wall of the Fairgrounds Office

Official Photographer

SKIBINSKI PHOTOGRAPHY • ROBERT J. SKIBINSKI

10766 Hanley St., Crown Point, IN 46307

219-755-0765 • skibinski2@aol.com • www.skibinskiphoto.com

Only the official photographer may take win pictures.

The AKC is committed to creating a safe and respectful sport environment for all. If you need to talk to someone, or need help, please call 800. 656.HOPE (National Sexual Assault Hotline) or text HOME to 741 741 for free, 24/7, confidential services from trained crisis counselors.



For information regarding Regulation, Entry and Eligibility for the AKC National Owner-Handled Series, please see www.AKC.org (Remember to check the box online or near the bottom of the entry form)



Join us for some **FUN!**

*Coffee and snacks will be available
each morning ~ while supplies last.*

Friday, June 12th

Dress in your best Red, White, & Blue today to help celebrate the United State's 250th anniversary!

Saturday, June 13th

While the Groups and Best in Show judging takes place, come by the GTKC Club table for our famous cheese party and enjoy a refreshing beverage.

Saturday & Sunday

We'll be holding an Armband Raffle for exhibitors! Write your name and phone number on the back of your Friday armband and bring it to the Club table for a drawing at Noon on Saturday. Any remaining or new armbands from Saturday will be entered into the Sunday drawing at Noon. The winners will receive a \$25 cash prize. Visit the Club table for more details.

Sunday, June 14th

Celebrate the conclusion of the Cherry Capital Classic and all your hard work! We'll be treating all participants to a delicious piece of cake as a token of our appreciation.

THE GRAND TRAVERSE KENNEL CLUB

*would like to dedicate this show
to our dear friends and members,
Stewart (Bing) Nunneley and John Peters
who both passed away recently.*

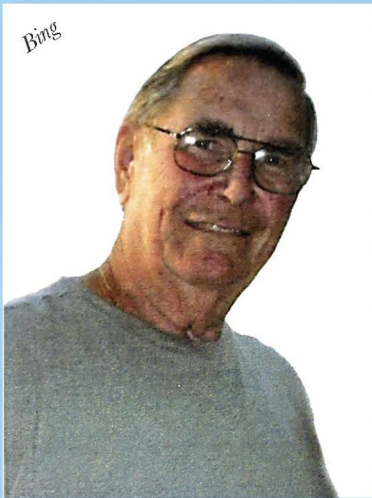

*Their years of dedication
are very much appreciated.*

FAST CAT

**Friday-Sunday
June 12-14th, 2026**

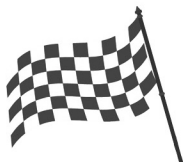

**HOW FAST
CAN YOUR DOG RUN
IN THIS 100 YARD DASH
FOR THE DOGS?!**



**Taking place during the
GTKC CHERRY CAPITAL CLASSIC DOG SHOW**
All AKC-Recognized Breeds | All American Dogs

Dogs must be AKC registered, so go online and register – it's easy!
www.akc.org/register/dog



NORTHWESTERN MICHIGAN FAIRGROUNDS

3806 Blair Town Hall Road • Traverse City, Michigan
Unlimited Camping with Water and 30/50 Amp Electric

Beth Clute, Chair | (231) 883-5233 | gtkfastcat@gmail.com
www.GrandTraverseKennelClub.com

Ribbon/Rosette Prizes

Regular Classes

First Prize	Blue
Second Prize	Red
Third Prize	Yellow
Fourth Prize	White
Winners	Purple
Reserve Winners	Purple & White
Best of Winners	Blue & White
Best of Breed/Variety	Purple & Gold
Best of Opposite Sex to Best of Breed/Variety	Red & White
Select Dog/Bitch	Light Blue & White

Non-Regular Classes

First Prize	Rose
Second Prize	Brown
Third Prize	Light Green
Fourth Prize	Gray
Best of Breed	Orange
Best of Opposite Sex to Best of Breed	Lavender
Best in Miscellaneous	Pink & Green
BPUP BOB	Orange
BPUP BOS	Lavender
BPUP BIS	Pink & Green
Best Junior Handler	Rose & Green
Reserve Best Junior Handler	Rose & Gray

Obedience Classes

Highest Scoring Dog in the Regular Obedience Classes	Blue & Gold
Highest Combined Score in Open Obedience Classes	Blue & Green
Qualifying Score	Dark Green

Rally Classes

High Scoring Triple Qualifying Score	Red & Blue
Highest Combined Score in Advanced B & Excellent B Rally Qualifying Score	Blue & Green Dark Green

Variety Groups

First Prize	Blue
Second Prize	Red
Third Prize	Yellow
Fourth Prize	White
Best in Show	Red, White & Blue
Reserve Best in Show	Misc. Colors

NOHS Breed & Variety Groups

Best of Breed/Variety	Maroon
First Prize	Neon Pink
Second Prize	Neon Green
Third Prize	Teal
Fourth Prize	Cream
Best in Show	Turquoise
Reserve Best in Show	Light Green

Classifications

Regular Classes (classes provided for dogs and bitches)

Puppy 6 months & under 9 months	Bred-by-Exhibitor Puppy
Puppy 9 months & under 12 months	Bred-by-Exhibitor Adult
Twelve to Eighteen Months	American Bred
Amateur Owner Handler	Open
	WINNERS

Best of Breed (Variety) Competition

The above classification is provided for all breeds (and varieties). Additional divisions, (i.e. age, color, or weight) are in the breed list and must be indicated on the entry.

Open Class Divisions

Retrievers (Labrador): Black; Chocolate; Yellow

Dachshunds (all three varieties): *Miniature* - 11 lbs. & under: 12 months old or over; *Standard* - over 11 lbs.; 11 lbs. & under if less than 12 months old

Boxers: Brindle; Fawn

Bullmastiffs: Brindle; AOAC

Doberman Pinschers: Black, AOAC

Giant Schnauzers: Black; Pepper and Salt

Great Danes: Black; Blue; Brindle; Fawn; Harlequin; Mantle; Merle

St. Bernards: Longhaired; Shorthaired

Pekingese: Open, Under 8 lbs. if 12 Months Old or Over; Open, 8 lbs. and Over (and Under 8 lbs. if less than 12 Months Old)

Pugs: Black; Fawn

Boston Terriers: Under 15 lbs.; 15 lbs. & over

Chinese Shar-Pei: Brush Coat; Horse Coat

Chow Chows: Black; Red; Any Other Color

Dalmatians: Black Spotted; Liver Spotted

Xoloitzcuintli: *Toy*-10-14 inches; *Miniature*-over 14-18 inches; *Standard*-over 18-23 inches

Australian Shepherds: Black; Blue Merle; Red; Red Merle

Collies (Rough): Blue Merle; Sable & White; Tri-Color; White

Shetland Sheepdogs: Sable & White; AOAC

There will be Puppy, Bred By Exhibitor, & Open Classes for each of the Misc. Breeds in each sex. Winners from these classes will compete for Best of Breed & Best of Opposite Sex to Best of Breed in each breed. Each Miscellaneous Best of Breed winner shall be eligible to compete for Best in Miscellaneous Class. All entries for Best in Miscellaneous Class shall be made after judging of the individual Miscellaneous breed classes. In the event that the owner of a dog designated Best of Breed shall not exhibit the dog in the Best of Miscellaneous Class Competition, no other dog of the same breed shall be allowed to compete. There shall be no further competition for dogs entered in the Miscellaneous Class. Ribbons shall conform to Chapter 5, Section 2 of AKC Rules.

SPECIAL ATTRACTIONS

Best Veteran in Show Competition Non-Regular Classes Involving Single Dog Entries Veterans

Combined class for dogs & bitches seven (7) years & over.

Friday Show 1 Only

Judge: Dr. Troy Dargin

The Grand Traverse Kennel Club, as part of its All-Breed Show 1 on Friday, will hold a Best Veteran in Show Competition. Competition will be for Best Veteran in Breed/Variety and Best Veteran in Show. There will be NO Veteran Group Competition.

During the course of judging, the assigned judge will select a Best Veteran in Breed/Variety. Dogs and bitches in this combined class MAY BE altered and WILL NOT compete for the points or in Regular Best of Breed Competition. This will be judged AFTER Best of Breed/Variety judging. All Best Veteran in Breed/Variety winners will compete for Best Veteran in Show.

Best Bred by Exhibitor in Show Competition

The Bred By Exhibitor Puppy and the Bred By Exhibitor Adult will compete in Bred By Exhibitor Groups and Best Bred By Exhibitor in Show. Judges, Group Order, and Ring times will be announced.

Friday Show 2

Best in Show Judge: Mrs. Honey Anne Glendinning
Sporting: Mrs. Mary Ellen Meyer, Hound: Dr. Troy Clifford Dargin,
Working: Donna Conod, Terrier: Mrs. Jo Ann Pavey,
Toy: Mrs. Jo Ann Pavey, Non-Sporting: Mrs. Mary Ellen Meyer,
Herding: Ms. Karen J Hynek, Miscellaneous: Ms. Karen J Hynek

Saturday

Best in Show Judge: Mrs. Jo Ann Pavey
Sporting: Mrs. Honey Anne Glendinning, Hound: Donna Conod,
Working: Dr. Troy Clifford Dargin, Terrier: Ms. Karen J Hynek,
Toy: Mrs. Mary Ellen Meyer, Non-Sporting: Dr. Troy Clifford Dargin,
Herding: Mrs. Honey Anne Glendinning, Miscellaneous: Mrs. Honey Anne Glendinning

Best Puppy in Show Competition Saturday

Best Puppy in Show Judge: Donna Conod

6-9 Puppy, 9-12 Puppy and the Bred By Exhibitor Puppy in this extravaganza will culminate to the Best Puppy in Show award. In this special event, Puppy class Winners in each breed/variety will be judged immediately following Best of Breed to determine Best Puppy. If a puppy wins Best of Breed/Variety or Best on Winners, it is automatically Best Puppy for that breed/variety. The Best puppy then competes in its respective Puppy Group and First through Forth placements. The first Place puppy Group winners will compete for Best Puppy in Show.

4-6 Month Beginner Puppy Competition

The Four-to-Six Month Puppy competition shall be for dogs that are four months of age and over but under six months on the day of the event. Classes will be offered for breeds and varieties and divided into Groups as described in Chapter 3, Section 1 of the *Rules Applying to Dog Shows* and the Miscellaneous Class breeds as listed in Chapter 3, Section 23. The Miscellaneous class competition will be the equivalent of Group competition and the winner will be eligible to compete in Best Four-to-Six Month Puppy in Show. The FSS competition will be the equivalent of Group competition and the winner will be eligible to compete in Best Four- to-Six Month Puppy in Show.

Entry and eligibility requirements include:

- The Four-to-Six Month Puppy event may be offered at licensed or member dog shows at the option of the show giving club.
- Four-to-Six Month Puppy Competition must be listed in the premium list, entry form and judging schedule, if offered.
- AKC registration number or an AKC litter number will be required for all entries of an AKC recognized breed as listed in Chapter 3, Section 1 of the Rules Applying to Dog Shows.
- A foreign born dog may enter this class if they are registered in the country of origin.
- FSS number or FSS registered litter number will be required for Miscellaneous and FSS breed entries.
- All entrants are to be vaccinated (including rabies) in accordance with their veterinarian's protocol.
- Dogs that are owned or co-owned by a professional handler may compete in this class, but must be handled by a non-professional handler. *Professional handlers are defined as any person who belongs or has belonged to a professional handlers' organization, distributed rate cards, or otherwise advertised or represented themselves as handling dogs for pay within the last five years. Dogs may not be exhibited by current assistants and household members of a professional handler.*

Obedience & Rally open to all AKC-Recognized Breeds & All American Dogs

OBEDIENCE CLASSES

OBEDIENCE ENTRIES PER AKC RULES & REGULATIONS PER TRIAL

Jump Heights in all applicable classes must be included on entry form.
Jump Height Order will begin with 36" and will be in descending order.

Regular Classes

Novice A, Novice B, Open A, Open B, Utility A, Utility B

Optional Titling Classes

Beginner Novice A, Beginner Novice B, Graduate Open, Graduate Novice, Versatility

RALLY CLASSES

RALLY ENTRIES PER AKC RULES & REGULATIONS PER TRIAL

Rally Regular Classes

Novice A • Novice B • Intermediate • Advanced A • Advanced B
Excellent A • Excellent B • Master • Choice

Transfers will be allowed at these Trials per AKC Regulations

Obedience Trials and Rally Trials

Rally Ring Size 40'x50'

In Obedience and Rally Classes requiring jumps, entries MUST include the Dog's Jump Height
Obedience and Rally Classes with Jumps will be judged in Descending Order beginning with 16"
Qualifying Score Required For All Prizes

Transfers will be allowed at this trial per AKC regulations

PLEASE NOTE: Request for refunds for bitches who come in season after entries close must be made in writing, accompanied by a veterinarian's certificate, and presented to the Superintendent no later than 30 minutes prior to the start of judging. Club will retain a \$10.00 processing fee.

JUNIOR SHOWMANSHIP COMPETITION

Novice Junior 9 & under 12 yrs • Open Junior 9 & under 12 yrs

Novice Intermediate 12 & under 15 yrs • Open Intermediate 12 & under 15 yrs

Novice Senior 15 & under 18 yrs • Open Senior 15 & under 18 yrs

Master Class

Novice Class - shall be for boys and girls who are at least 9 years old and under 18 years old on the day of the show and who at the time entries close have not won three (3) first place awards, with competition present, in a Novice Class. A first place in Novice without competition leading to a Best Junior award with competition would count as one win towards moving to Open at a licensed or member show. Junior Handlers who win a third Novice Class with competition, if a win in Novice leads to a Best Junior with competition present it will count as one win towards moving to Open, after the closing of entries for a show are required to transfer their entry from the Novice Class to the Open Class by notifying the Superintendent or Show Secretary prior to the judging of the class at the show.

Open Class - shall be for boys and girls who are at least 9 years old and under 18 years old on the day of the show and who have won three (3) first place awards in a Novice Class or if a win in Novice leads to a Best Junior with competition present it will count as one win towards moving to Open in a licensed or member show.

Master Class - will be for boys & girls who are at least 9 years old and under 18 years on the day of the show, and who have won 10 Best Junior wins with competition. The calendar for this class will be consistent with the eligibility dates for the AKC National Championship. All Juniors meeting the criteria for this class are required to enter the Master Class and must change their entry the day of the show if entries have already closed. Once the eligibility time frame for that year has passed all participants return to the Open Class to complete for the following year.

No entry may be changed or cancelled unless notice of the change or cancellation is received in writing by the Superintendent or Show Secretary named in the premium list to receive entries, prior to the closing date and hour for entries, except that a correction may be made from one age division to another, as well as, move from Master to Open or Open to Novice if a win has been disallowed or the Junior miscalculated number of placements, provided this transfer is made by the Superintendent or Show Secretary prior to the judging of the class at the show.

NOTICE: Junior Handlers must include their AKC JUNIOR HANDLER NUMBER on each entry.

You may obtain your junior identification number by calling the AKC, Judges Education Department (919) 233-9767.

RAMP OPTIONAL BREEDS: At the discretion of the judge through all levels of competition including group and Best in Show judging.

AMERICAN WATER SPANIEL

BOYKIN SPANIEL

FIELD SPANIEL

NS DUCK TOLLING RETRIEVER

WELSH SPRINGER SPANIEL

BASENJI (or Table)

BASSET FAUVE DE BRETAGNE

GRAND BASSET GRIFFON VENDEEN

NORWEGIAN ELKHOUND

WHIPPET

GERMAN PINSCHER

PORTUGUESE WATER DOG

STANDARD SCHNAUZER

AMERICAN STAFFORDSHIRE TERRIER

IRISH TERRIER

MINIATURE BULL TERRIER (Ground/Table)

SOFT COATED WHEATEN TERRIER

STAFFORDSHIRE BULL TERRIER

FINNISH SPITZ

AUSTRALIAN CATTLE DOG

ENTLEBUCHER MOUNTAIN DOG

FINNISH LAPPHUND

ICELANDIC SHEEPDOG

MUDI (or Table)

NORWEGIAN BUHUND

POLISH LOWLAND SHEEPDOG

PULI (or Table)

NORRBOTTENSPET (Misc.)

NOTE: Ramps can be used in emergency situations to judge any breed. See next page for ramp emergency use information.

BREEDS THAT MUST BE JUDGED ON RAMP: Applies to all conformation competition associated with AKC conformation dog shows or at any event at which an AKC conformation title may be earned.

CLUMBER SPANIEL

ENGLISH SPRINGER SPANIEL

LAGOTTO ROMAGNOLA

SUSSEX SPANIEL

BASSET HOUND

CIRNECO DELL'ETNA

KERRY BLUE TERRIER

BULLDOGS

CHINESE SHAR-PEI

CHOW CHOW

KEESHOND

SPANISH WATER DOG

see www.akc.org for updates or more information

REVISED 02/09/2026

Judges

Donna Conod (94843)	12045 ELLIOTT ROAD, RR 3, TILLSONBURG, ON N4G 4G8
Dr. Troy Clifford Dargin (15445)	1153 PLANK RD, AVERILL PARK, NY 12018
Amede DeCruydt (43367)	25515 URSULINE ST, ST CLR SHORES, MI 48081
Mrs. Honey Anne Glendinning (6773)	170 BLACKFOOT COURT WEST, LETHBRIDGE, AB T1K 7W1
Ms. Karen J Hynek (35536)	11801 LINKS RD, MARTHASVILLE, MO 63357
Mrs. Mary Ellen Meyer (16134)	810 ONTARIO AVE, OOSTBURG, WI 53070
Mrs. Jo Ann Pavey (98431)	85 SELINE CRESCENT, BARRIE, ON L4N 5V7
Mrs. Linda Scanlon (2793)	PO BOX 4559, EAGLE, CO 81631
Ms. Cheryl A Shea (43266)	4998 LINDSEY RD, DELTON, MI 49046

Please Note: (*) appearing after a judge's name/assignment denotes provisional status for that assignment at the time of judge panel processing.

Judge Assignments

	Friday 1	Friday 2	Saturday	Sunday
Best In Show	K Hynek	D Conod	T Dargin	J Pavey
NOHS Best In Show	~ not offered ~	K Hynek	D Conod	H Glendinning
Sporting Group	K Hynek	T Dargin	D Conod	J Pavey
NOHS Sporting Group	~ not offered ~	K Hynek	T Dargin	D Conod
Barbet	H Glendinning	J Pavey	K Hynek	T Dargin
Bracco Italiano	H Glendinning	J Pavey	K Hynek	T Dargin
Brittany	H Glendinning	J Pavey	K Hynek	T Dargin
Lagotto Romagnolo	H Glendinning	J Pavey	K Hynek	T Dargin
Nederlandse Kooikerhondje	H Glendinning	J Pavey	K Hynek	T Dargin
Pointer	H Glendinning	J Pavey	K Hynek	T Dargin
German Shorthaired Pointer	H Glendinning	J Pavey	K Hynek	T Dargin
German Wirehaired Pointer	H Glendinning	J Pavey	K Hynek	T Dargin
Chesapeake Bay Retriever	H Glendinning	J Pavey	K Hynek	T Dargin
Curly-Coated Retriever	H Glendinning	J Pavey	K Hynek	T Dargin
Flat-Coated Retriever	H Glendinning	J Pavey	K Hynek	T Dargin
Golden Retriever	H Glendinning	J Pavey	K Hynek	T Dargin
Labrador Retriever	H Glendinning	J Pavey	K Hynek	T Dargin
Nova Scotia Duck Tolling Ret	H Glendinning	J Pavey	K Hynek	T Dargin
English Setter	H Glendinning	J Pavey	K Hynek	T Dargin
Gordon Setter	H Glendinning	J Pavey	K Hynek	T Dargin
Irish Setter	H Glendinning	J Pavey	K Hynek	T Dargin
Irish Red and White Setter	H Glendinning	J Pavey	K Hynek	T Dargin
American Water Spaniel	H Glendinning	J Pavey	K Hynek	T Dargin
Boykin Spaniel	H Glendinning	J Pavey	K Hynek	T Dargin
Clumber Spaniel	H Glendinning	J Pavey	K Hynek	T Dargin
Cocker Spaniel Black	H Glendinning	J Pavey	K Hynek	T Dargin
Cocker Spaniel ASCOB	H Glendinning	J Pavey	K Hynek	T Dargin
Cocker Spaniel Parti	H Glendinning	J Pavey	K Hynek	T Dargin
English Cocker Spaniel	H Glendinning	J Pavey	K Hynek	T Dargin
English Springer Spaniel	H Glendinning	J Pavey	K Hynek	T Dargin
Field Spaniel	H Glendinning	J Pavey	K Hynek	T Dargin
Irish Water Spaniel	H Glendinning	J Pavey	K Hynek	T Dargin
Sussex Spaniel	H Glendinning	J Pavey	K Hynek	T Dargin
Welsh Springer Spaniel	H Glendinning	J Pavey	K Hynek	T Dargin
Spinone Italiano	H Glendinning	J Pavey	K Hynek	T Dargin
Vizsla	H Glendinning	J Pavey	K Hynek	T Dargin
Weimaraner	H Glendinning	J Pavey	K Hynek	T Dargin
Wirehaired Pointing Griffon	H Glendinning	J Pavey	K Hynek	T Dargin
Wirehaired Vizsla	H Glendinning	J Pavey	K Hynek	T Dargin

* See Page 7 for Open Class Divisions.

	Friday 1	Friday 2	Saturday	Sunday
Hound Group	H Glendinning(*)	D Conod	K Hynek	J Pavey
NOHS Hound Group	~ not offered ~	J Pavey	H Glendinning	D Conod
Afghan Hound	D Conod	K Hynek	J Pavey	H Glendinning(*)
American English Coonhound	D Conod	K Hynek	J Pavey	H Glendinning(*)
American Foxhound	D Conod	K Hynek	J Pavey	H Glendinning(*)
Azawakh	D Conod	K Hynek	J Pavey	H Glendinning
Basenji	D Conod	K Hynek	J Pavey	H Glendinning(*)
Basset Fauve de Bretagne	D Conod	K Hynek	J Pavey	H Glendinning(*)
Basset Hound	D Conod	K Hynek	J Pavey	H Glendinning(*)
Beagle (13 in. and under)	D Conod	K Hynek	J Pavey	H Glendinning
Beagle (over 13 in.)	D Conod	K Hynek	J Pavey	H Glendinning
Black and Tan Coonhound	D Conod	K Hynek	J Pavey	H Glendinning(*)
Bloodhound	D Conod	K Hynek	J Pavey	H Glendinning
Bluetick Coonhound	D Conod	K Hynek	J Pavey	H Glendinning(*)
Borzoi	D Conod	K Hynek	J Pavey	H Glendinning(*)
Cirneco dell'Etna	D Conod	K Hynek	J Pavey	H Glendinning(*)
Dachshund (Longhaired)	D Conod	K Hynek	J Pavey	H Glendinning
Dachshund (Smooth)	D Conod	K Hynek	J Pavey	H Glendinning
Dachshund (Wirehaired)	D Conod	K Hynek	J Pavey	H Glendinning
English Foxhound	D Conod	K Hynek	J Pavey	H Glendinning(*)
Grand Basset Griffon Vendéen	D Conod	K Hynek	J Pavey	H Glendinning
Greyhound	D Conod	K Hynek	J Pavey	H Glendinning
Harrier	D Conod	K Hynek	J Pavey	H Glendinning(*)
Ibizan Hound	D Conod	K Hynek	J Pavey	H Glendinning
Irish Wolfhound	D Conod	K Hynek	J Pavey	H Glendinning
Norwegian Elkhound	D Conod	K Hynek	J Pavey	H Glendinning
Otterhound	D Conod	K Hynek	J Pavey	H Glendinning
Petit Basset Griffon Vendéen	D Conod	K Hynek	J Pavey	H Glendinning
Pharaoh Hound	D Conod	K Hynek	J Pavey	H Glendinning
Plott Hound	D Conod	K Hynek	J Pavey	H Glendinning(*)
Portuguese Podengo Pequeno	D Conod	K Hynek	J Pavey	H Glendinning
Redbone Coonhound	D Conod	K Hynek	J Pavey	H Glendinning(*)
Rhodesian Ridgeback	D Conod	K Hynek	J Pavey	H Glendinning(*)
Saluki	D Conod	K Hynek	J Pavey	H Glendinning(*)
Scottish Deerhound	D Conod	K Hynek	J Pavey	H Glendinning
Sloughi	D Conod	K Hynek	J Pavey	H Glendinning(*)
Treeing Walker Coonhound	D Conod	K Hynek	J Pavey	H Glendinning(*)
Whippet	D Conod	K Hynek	J Pavey	H Glendinning(*)
Working Group	J Pavey	K Hynek	D Conod	H Glendinning
NOHS Working Group	~ not offered ~	J Pavey	K Hynek	D Conod
Akita	K Hynek	D Conod	H Glendinning	J Pavey
Alaskan Malamute	K Hynek	D Conod	H Glendinning	J Pavey
Anatolian Shepherd Dog	K Hynek	D Conod	H Glendinning	J Pavey
Bernese Mountain Dog	K Hynek	D Conod	H Glendinning	J Pavey
Black Russian Terrier	K Hynek	D Conod	H Glendinning	J Pavey
Boerboel	K Hynek	D Conod	H Glendinning	J Pavey
Boxer	K Hynek	D Conod	H Glendinning	J Pavey
Bullmastiff	K Hynek	D Conod	H Glendinning	J Pavey
Cane Corso	K Hynek	D Conod	H Glendinning	J Pavey
Chinook	K Hynek	D Conod	H Glendinning	J Pavey
Danish-Swedish Farmdog	K Hynek	D Conod	H Glendinning	J Pavey
Doberman Pinscher	K Hynek	D Conod	H Glendinning	J Pavey
Dogo Argentino	K Hynek	D Conod	H Glendinning	J Pavey
Dogue de Bordeaux	K Hynek	D Conod	H Glendinning	J Pavey
German Pinscher	K Hynek	D Conod	H Glendinning	J Pavey
Giant Schnauzer	K Hynek	D Conod	H Glendinning	J Pavey
Great Dane	K Hynek	D Conod	H Glendinning	J Pavey
Great Pyrenees	K Hynek	D Conod	H Glendinning	J Pavey
Greater Swiss Mountain Dog	K Hynek	D Conod	H Glendinning	J Pavey
Komondor	K Hynek	D Conod	H Glendinning	J Pavey

* See Page 7 for Open Class Divisions.

	Friday 1	Friday 2	Saturday	Sunday
Kuvasz	K Hynek	D Conod	H Glendinning	J Pavey
Leonberger	K Hynek	D Conod	H Glendinning	J Pavey
Mastiff	K Hynek	D Conod	H Glendinning	J Pavey
Neapolitan Mastiff	K Hynek	D Conod	H Glendinning	J Pavey
Newfoundland	K Hynek	D Conod	H Glendinning	J Pavey
Portuguese Water Dog	K Hynek	D Conod	H Glendinning	J Pavey
Rottweiler	K Hynek	D Conod	H Glendinning	J Pavey
St. Bernard	K Hynek	D Conod	H Glendinning	J Pavey
Samoyed	K Hynek	D Conod	H Glendinning	J Pavey
Siberian Husky	K Hynek	D Conod	H Glendinning	J Pavey
Standard Schnauzer	K Hynek	D Conod	H Glendinning	J Pavey
Tibetan Mastiff	K Hynek	D Conod	H Glendinning	J Pavey
Terrier Group	J Pavey	T Dargin	K Hynek(*)	D Conod
NOHS Terrier Group	~ not offered ~	K Hynek	D Conod	H Glendinning
Airedale Terrier	K Hynek(*)	D Conod	T Dargin	J Pavey
American Hairless Terrier	K Hynek(*)	D Conod	T Dargin	J Pavey
American Staffordshire Terrier	K Hynek	D Conod	T Dargin	J Pavey
Australian Terrier	K Hynek(*)	D Conod	T Dargin	J Pavey
Bedlington Terrier	K Hynek(*)	D Conod	T Dargin	J Pavey
Border Terrier	K Hynek	D Conod	T Dargin	J Pavey
Colored Bull Terrier	K Hynek	D Conod	T Dargin	J Pavey
White Bull Terrier	K Hynek	D Conod	T Dargin	J Pavey
Cairn Terrier	K Hynek	D Conod	T Dargin	J Pavey
Cesky Terrier	K Hynek	D Conod	T Dargin	J Pavey
Dandie Dinmont Terrier	K Hynek(*)	D Conod	T Dargin	J Pavey
Smooth Fox Terrier	K Hynek	D Conod	T Dargin	J Pavey
Wire Fox Terrier	K Hynek	D Conod	T Dargin	J Pavey
Glen of Imaal Terrier	K Hynek(*)	D Conod	T Dargin	J Pavey
Irish Terrier	K Hynek	D Conod	T Dargin	J Pavey
Kerry Blue Terrier	K Hynek(*)	D Conod	T Dargin	J Pavey
Lakeland Terrier	K Hynek(*)	D Conod	T Dargin	J Pavey
Standard Manchester Terrier	K Hynek	D Conod	T Dargin	J Pavey
Miniature Bull Terrier	K Hynek	D Conod	T Dargin	J Pavey
Miniature Schnauzer	K Hynek	D Conod	T Dargin	J Pavey
Norfolk Terrier	K Hynek	D Conod	T Dargin	J Pavey
Norwich Terrier	K Hynek	D Conod	T Dargin	J Pavey
Parson Russell Terrier	K Hynek	D Conod	T Dargin	J Pavey
Rat Terrier	K Hynek(*)	D Conod	T Dargin	J Pavey
Russell Terrier	K Hynek	D Conod	T Dargin	J Pavey
Scottish Terrier	K Hynek	D Conod	T Dargin	J Pavey
Sealyham Terrier	K Hynek(*)	D Conod	T Dargin	J Pavey
Skye Terrier	K Hynek(*)	D Conod	T Dargin	J Pavey
Soft Coated Wheaten Terrier	K Hynek	D Conod	T Dargin	J Pavey
Staffordshire Bull Terrier	K Hynek	D Conod	T Dargin	J Pavey
Teddy Roosevelt Terrier	K Hynek(*)	D Conod	T Dargin	J Pavey
Welsh Terrier	K Hynek(*)	D Conod	T Dargin	J Pavey
West Highland White Terrier	K Hynek	D Conod	T Dargin	J Pavey
Toy Group	D Conod	J Pavey	T Dargin	M Meyer(*)
NOHS Toy Group	~ not offered ~	T Dargin	M Meyer	J Pavey
Affenpinscher	J Pavey	T Dargin	M Meyer	D Conod
Biewer Terrier	J Pavey	T Dargin	M Meyer	D Conod
Brussels Griffon	J Pavey	T Dargin	M Meyer	D Conod
Cavalier King Charles Spaniel	J Pavey	T Dargin	M Meyer	D Conod
Long Coat Chihuahua	J Pavey	T Dargin	M Meyer	D Conod
Smooth Coat Chihuahua	J Pavey	T Dargin	M Meyer	D Conod
Chinese Crested	J Pavey	T Dargin	M Meyer	D Conod
B & P C English Toy Spaniel	J Pavey	T Dargin	M Meyer	D Conod
K C & R English Toy Spaniel	J Pavey	T Dargin	M Meyer	D Conod
Havanese	J Pavey	T Dargin	M Meyer	D Conod
Italian Greyhound	J Pavey	T Dargin	M Meyer	D Conod

** See Page 7 for Open Class Divisions.*

	Friday 1	Friday 2	Saturday	Sunday
Japanese Chin	J Pavey	T Dargin	M Meyer(*)	D Conod
Maltese	J Pavey	T Dargin	M Meyer	D Conod
Toy Manchester Terrier	J Pavey	T Dargin	M Meyer	D Conod
Miniature Pinscher	J Pavey	T Dargin	M Meyer	D Conod
Papillon	J Pavey	T Dargin	M Meyer	D Conod
Pekingese	J Pavey	T Dargin	M Meyer	D Conod
Pomeranian	J Pavey	T Dargin	M Meyer	D Conod
Toy Poodle	J Pavey	T Dargin	M Meyer	D Conod
Pug	J Pavey	T Dargin	M Meyer	D Conod
Russian Toy	J Pavey	T Dargin	M Meyer	D Conod
Russian Tsvetnaya Bolonka	J Pavey	T Dargin	M Meyer(*)	D Conod
Shih Tzu	J Pavey	T Dargin	M Meyer	D Conod
Silky Terrier	J Pavey	T Dargin	M Meyer	D Conod
Toy Fox Terrier	J Pavey	T Dargin	M Meyer	D Conod
Yorkshire Terrier	J Pavey	T Dargin	M Meyer	D Conod
Non-Sporting Group	D Conod	T Dargin	J Pavey	H Glendinning
NOHS Non-Sporting Group	~ not offered ~	J Pavey	M Meyer	T Dargin
American Eskimo Dog	H Glendinning	J Pavey	T Dargin	M Meyer
Bichon Frise	H Glendinning	J Pavey	T Dargin	M Meyer
Boston Terrier	H Glendinning	J Pavey	T Dargin	M Meyer
Bulldog	H Glendinning	J Pavey	T Dargin	M Meyer
Chinese Shar-Pei	H Glendinning	J Pavey	T Dargin	M Meyer
Chow Chow	H Glendinning	J Pavey	T Dargin	M Meyer
Coton de Tulear	H Glendinning	J Pavey	T Dargin	M Meyer
Dalmatian	H Glendinning	J Pavey	T Dargin	M Meyer
Finnish Spitz	H Glendinning	J Pavey	T Dargin	M Meyer
French Bulldog	H Glendinning	J Pavey	T Dargin	M Meyer
Keeshond	H Glendinning	J Pavey	T Dargin	M Meyer
Lhasa Apso	H Glendinning	J Pavey	T Dargin	M Meyer
Lowchen	H Glendinning	J Pavey	T Dargin	M Meyer
Norwegian Lundehund	H Glendinning	J Pavey	T Dargin	M Meyer
Miniature Poodle	H Glendinning	J Pavey	T Dargin	M Meyer
Standard Poodle	H Glendinning	J Pavey	T Dargin	M Meyer
Schipperke	H Glendinning	J Pavey	T Dargin	M Meyer
Shiba Inu	H Glendinning	J Pavey	T Dargin	M Meyer
Tibetan Spaniel	H Glendinning	J Pavey	T Dargin	M Meyer
Tibetan Terrier	H Glendinning	J Pavey	T Dargin	M Meyer
Xoloitzcuintli	H Glendinning	J Pavey	T Dargin	M Meyer
Herding Group	H Glendinning	D Conod	K Hynek	J Pavey
NOHS Herding Group	~ not offered ~	J Pavey	H Glendinning	D Conod
Australian Cattle Dog	D Conod	K Hynek	J Pavey	H Glendinning
Australian Shepherd	D Conod	K Hynek	J Pavey	H Glendinning
Bearded Collie	D Conod	K Hynek	J Pavey	H Glendinning
Beauceron	D Conod	K Hynek	J Pavey	H Glendinning
Belgian Laekenois	D Conod	K Hynek	J Pavey	H Glendinning
Belgian Malinois	D Conod	K Hynek	J Pavey	H Glendinning
Belgian Sheepdog	D Conod	K Hynek	J Pavey	H Glendinning
Belgian Tervuren	D Conod	K Hynek	J Pavey	H Glendinning
Bergamasco Sheepdog	D Conod	K Hynek	J Pavey	H Glendinning
Berger Picard	D Conod	K Hynek	J Pavey	H Glendinning
Border Collie	D Conod	K Hynek	J Pavey	H Glendinning
Bouvier des Flandres	D Conod	K Hynek	J Pavey	H Glendinning
Briard	D Conod	K Hynek	J Pavey	H Glendinning
Canaan Dog	D Conod	K Hynek	J Pavey	H Glendinning
Cardigan Welsh Corgi	D Conod	K Hynek	J Pavey	H Glendinning
Rough Collie	D Conod	K Hynek	J Pavey	H Glendinning
Smooth Collie	D Conod	K Hynek	J Pavey	H Glendinning
Entlebucher Mountain Dog	D Conod	K Hynek	J Pavey	H Glendinning
Finnish Lapphund	D Conod	K Hynek	J Pavey	H Glendinning
German Shepherd Dog	D Conod	K Hynek	J Pavey	H Glendinning

** See Page 7 for Open Class Divisions.*

	Friday 1	Friday 2	Saturday	Sunday
Icelandic Sheepdog	D Conod	K Hynek	J Pavey	H Glendinning
Lancashire Heeler	D Conod	K Hynek	J Pavey	H Glendinning
Miniature American Shepherd	D Conod	K Hynek	J Pavey	H Glendinning
Mudi	D Conod	K Hynek	J Pavey	H Glendinning
Norwegian Buhund	D Conod	K Hynek	J Pavey	H Glendinning
Old English Sheepdog	D Conod	K Hynek	J Pavey	H Glendinning
Pembroke Welsh Corgi	D Conod	K Hynek	J Pavey	H Glendinning
Polish Lowland Sheepdog	D Conod	K Hynek	J Pavey	H Glendinning
Puli	D Conod	K Hynek	J Pavey	H Glendinning
Pumi	D Conod	K Hynek	J Pavey	H Glendinning
Pyrenean Shepherd	D Conod	K Hynek	J Pavey	H Glendinning
Shetland Sheepdog	D Conod	K Hynek	J Pavey	H Glendinning
Spanish Water Dog	D Conod	K Hynek	J Pavey	H Glendinning
Swedish Vallhund	D Conod	K Hynek	J Pavey	H Glendinning
Miscellaneous	H Glendinning	T Dargin	K Hynek	D Conod
Alaskan Klee Kai	H Glendinning	T Dargin	K Hynek	D Conod
Bolognese	H Glendinning	T Dargin	K Hynek	D Conod
Czechoslovakian Vlcia	H Glendinning	T Dargin	K Hynek	D Conod
Dutch Shepherd	H Glendinning	T Dargin	K Hynek	D Conod
German Spitz	H Glendinning	T Dargin	K Hynek	D Conod
Japanese Akitainu	H Glendinning	T Dargin	K Hynek	D Conod
Kai Ken	H Glendinning	T Dargin	K Hynek	D Conod
Norrbottenspets	H Glendinning	T Dargin	K Hynek	D Conod
Peruvian Inca Orchid	H Glendinning	T Dargin	K Hynek	D Conod
Portuguese Podengo	H Glendinning	T Dargin	K Hynek	D Conod
Pyrenean Mastiff	H Glendinning	T Dargin	K Hynek	D Conod
Small Munsterlander	H Glendinning	T Dargin	K Hynek	D Conod
Yakutian Laika	H Glendinning	T Dargin	K Hynek	D Conod
Junior Showmanship	~ not offered ~	L Scanlon	M Meyer	T Dargin
Best Begnr. Puppy In Show	~ not offered ~	~ not offered ~	D Conod	~ not offered ~
Begnr. Puppy - Sporting Group	~ not offered ~	~ not offered ~	D Conod	~ not offered ~
Begnr. Puppy - Hound Group	~ not offered ~	~ not offered ~	D Conod	~ not offered ~
Begnr. Puppy - Working Group	~ not offered ~	~ not offered ~	D Conod	~ not offered ~
Begnr. Puppy - Terrier Group	~ not offered ~	~ not offered ~	D Conod	~ not offered ~
Begnr. Puppy - Toy Group	~ not offered ~	~ not offered ~	D Conod	~ not offered ~
Begnr. Puppy - Non-Sporting Grp	~ not offered ~	~ not offered ~	D Conod	~ not offered ~
Begnr. Puppy - Herding Group	~ not offered ~	~ not offered ~	D Conod	~ not offered ~
Begnr. Puppy - Misc Breeds	~ not offered ~	~ not offered ~	D Conod	~ not offered ~
Begnr. Pup-FSSbreeds(Ex.Misc)	~ not offered ~	~ not offered ~	D Conod	~ not offered ~
Obedience Novice A	~ not offered ~	~ not offered ~	L Scanlon	L Scanlon
Obedience Novice B	~ not offered ~	~ not offered ~	L Scanlon	L Scanlon
Obedience Beginner Novice A	~ not offered ~	~ not offered ~	L Scanlon	L Scanlon
Obedience Beginner Novice B	~ not offered ~	~ not offered ~	L Scanlon	L Scanlon
Obedience Graduate Novice	~ not offered ~	~ not offered ~	L Scanlon	L Scanlon
Obedience Open A	~ not offered ~	~ not offered ~	L Scanlon	L Scanlon
Obedience Open B	~ not offered ~	~ not offered ~	L Scanlon	L Scanlon
Obedience Graduate Open	~ not offered ~	~ not offered ~	L Scanlon	L Scanlon
Obedience Utility A	~ not offered ~	~ not offered ~	L Scanlon	L Scanlon
Obedience Utility B	~ not offered ~	~ not offered ~	L Scanlon	L Scanlon
Obedience Versatility	~ not offered ~	~ not offered ~	L Scanlon	L Scanlon
Rally Novice A	A DeCruydt	L Scanlon	C Shea	~ not offered ~
Rally Novice B	A DeCruydt	L Scanlon	C Shea	~ not offered ~
Rally Intermediate	A DeCruydt	L Scanlon	C Shea	~ not offered ~
Rally Advanced A	A DeCruydt	L Scanlon	C Shea	~ not offered ~
Rally Advanced B	A DeCruydt	L Scanlon	C Shea	~ not offered ~
Rally Excellent A	A DeCruydt	L Scanlon	C Shea	~ not offered ~
Rally Excellent B	A DeCruydt	L Scanlon	C Shea	~ not offered ~
Rally Master	A DeCruydt	L Scanlon	C Shea	~ not offered ~
Rally Choice	A DeCruydt	L Scanlon	C Shea	~ not offered ~

** See Page 7 for Open Class Divisions.*



Grand Traverse Kennel Club

(Licensed by the American Kennel Club)

Officers

Sheila Tatman..... President
 Rob Eshleman..... Vice President
 Julie Tripp Treasurer
 Beth Clute..... Secretary
 4617 Manor Wood Drive S, Traverse City, MI 49685 • 231-883-5233 • gtkcfastcat@gmail.com

Board of Directors

Jamie Bain • Chris Bassett • Ann Eshleman • Randy Jagielo • Ceclia Williams

Show Committee

Carolyn Hoffmann Show Chair
 887 Wind Drift Dr., Traverse City, MI 49684 • 248-535-0091 • tseyi01@gmail.com

Julie Tripp Show Co-Chair
 1099 Vega Dr., Traverse City, MI 49696 • 231-218-8258 • tripplabradors@gmail.com

Sheila Tatman.....Obedience & Rally Chair
 9880 E Bingham Road, Traverse City, MI 49684 • 727-282-9291 • sheilatatman@gmail.com

Event Committee

Tawnya Churchill • Rob Eshleman • Jill Saarella • Sheila Tatman • Julie Tripp

Committees

Julie TrippAdvertising & Catalog
 Tawnya Churchill Grounds
 Ann Eshleman..... Trophies
 Jill Saarella Hospitality
 Rob Eshleman..... Parking
 Carolyn Hoffmann Emergency Coordinator
 Karen Elliott..... Chief Ring Steward

12260 Cardova Ct., Sterling Heights, MI 48312

Vendors

Interested Vendors, please contact: Carolyn Hoffmann
 248-535-0091 • tseyi01@gmail.com

The Show Chair will not handle dogs in Breed Competition.

~~ Indoor Grooming, Unlimited Camping & Close to Grand Traverse Bay ~~

website: <https://grandtraversekennelclub.com/>

Facebook: [Grand Traverse KC](#)



FRIDAY Show 1 & 2

BEST IN SHOW & VARIETY GROUP PRIZES

FOR BEST IN SHOW

\$100 and Rosette offered by the Grand Traverse Kennel Club

FOR RESERVE BEST IN SHOW

\$50 and Rosette offered by the Grand Traverse Kennel Club

FOR FIRST THROUGH FOURTH IN EACH REGULAR VARIETY GROUP

Rosette offered by the Grand Traverse Kennel Club

FOR NOHS BEST IN SHOW (Show 2)

Gift offered by Rob & Ann Eshleman

Rosette offered by the Grand Traverse Kennel Club

FOR NOHS RESERVE BEST IN SHOW

Rosette offered by the Grand Traverse Kennel Club

FOR FIRST THROUGH FOURTH IN EACH NOHS VARIETY GROUP

Rosette offered by the Grand Traverse Kennel Club

FOR BEST VETERAN IN SHOW (Show 1)

Rosette offered by Grand Traverse Kennel Club

Gift of Cherry Products offered by Cherry Republic

FOR FIRST THROUGH FOURTH IN EACH VETERAN VARIETY GROUP

Rosette offered by the Grand Traverse Kennel Club

FOR BRED BY EXHIBITOR IN SHOW (Show 2)

Gift offered by J & J Custom Creations

Rosette offered by the Grand Traverse Kennel Club

AKC will offer "One free Litter Registration" to the winner.

FOR FIRST THROUGH FOURTH IN EACH BRED BY EXHIBITOR VARIETY GROUP

Rosette offered by the Grand Traverse Kennel Club

JUNIOR SHOWMANSHIP COMPETITION PRIZES

BEST JUNIOR HANDLER

Rosette & \$50 Gift Card offered by the Grand Traverse Kennel Club

Full color 8x10 photograph offered by Skibinski Photography

RESERVE BEST JUNIOR HANDLER

Rosette offered by the Grand Traverse Kennel Club

RALLY PRIZES

Rosettes offered by Grand Traverse Kennel Club for:

Highest Combine Advanced, Excellent and Master

Highest Combined Score in Advanced B & Excellent B Classes

Qualifying Ribbons

First through Fourth in Each Class

SATURDAY

BEST IN SHOW & VARIETY GROUP PRIZES

FOR BEST IN SHOW

\$100 and Rosette offered by the Grand Traverse Kennel Club

FOR RESERVE BEST IN SHOW

\$50 and Rosette offered by the Grand Traverse Kennel Club

FOR FIRST THROUGH FOURTH IN EACH REGULAR VARIETY GROUP

Rosette offered by the Grand Traverse Kennel Club

FOR NOHS BEST IN SHOW

Gift offered by Rob & Ann Eshleman

Rosette offered by the Grand Traverse Kennel Club

FOR NOHS RESERVE BEST IN SHOW

Rosette offered by the Grand Traverse Kennel Club

FOR FIRST THROUGH FOURTH IN EACH NOHS VARIETY GROUP

Rosette offered by the Grand Traverse Kennel Club

FOR BEST PUPPY IN SHOW

Rosette is offered by the Grand Traverse Kennel Club.

Gift offered by Tawnya Churchill

FOR FIRST THROUGH FOURTH IN EACH PUPPY VARIETY GROUP

Rosette offered by the Grand Traverse Kennel Club

FOR BRED BY EXHIBITOR IN SHOW

Gift offered by J & J Custom Creations

Rosette offered by the Grand Traverse Kennel Club

AKC will offer "One free Litter Registration" to the winner.

FOR FIRST THROUGH FOURTH IN EACH BRED BY EXHIBITOR VARIETY GROUP

Rosette offered by the Grand Traverse Kennel Club

FOR BEST 4-6 MONTH BEGINNER PUPPY IN SHOW

Rosette offered by Grand Traverse Kennel Club

Gift offered by Tawnya Churchill

JUNIOR SHOWMANSHIP COMPETITION PRIZES

BEST JUNIOR HANDLER

Rosette & \$50 Gift Card offered by the Grand Traverse Kennel Club

Full color 8x10 photograph offered by Skibinski Photography

RESERVE BEST JUNIOR HANDLER

Rosette offered by the Grand Traverse Kennel Club

OBEDIENCE TRIAL PRIZES

Rosettes offered by Grand Traverse Kennel Club for the following

High in Trial & High Combined

Qualifying Ribbons

First through Fourth in Each Class

RALLY PRIZES

Rosettes offered by Grand Traverse Kennel Club for:

Highest Combine Advanced, Excellent and Master
Highest Combined Score in Advanced B & Excellent B Classes

Qualifying Ribbons

First through Fourth in Each Class

SUNDAY
BEST IN SHOW & VARIETY GROUP PRIZES

FOR BEST IN SHOW

\$100 and Rosette offered by the Grand Traverse Kennel Club

FOR RESERVE BEST IN SHOW

\$50 and Rosette offered by the Grand Traverse Kennel Club

FOR FIRST THROUGH FOURTH IN EACH REGULAR VARIETY GROUP

Rosette offered by the Grand Traverse Kennel Club

FOR NOHS BEST IN SHOW

Gift offered by Tripp Labradors

Rosette offered by the Grand Traverse Kennel Club

FOR NOHS RESERVE BEST IN SHOW

Rosette offered by the Grand Traverse Kennel Club

FOR FIRST THROUGH FOURTH IN EACH NOHS VARIETY GROUP

Rosette offered by the Grand Traverse Kennel Club

JUNIOR SHOWMANSHIP COMPETITION PRIZES

BEST JUNIOR HANDLER

Rosette & \$50 Gift Card offered by the Grand Traverse Kennel Club

Full color 8x10 photograph offered by Skibinski Photography

RESERVE BEST JUNIOR HANDLER

Rosette offered by the Grand Traverse Kennel Club

OBEDIENCE TRIAL PRIZES

Rosettes offered by Grand Traverse Kennel Club for the following

High in Trial & High Combined

Qualifying Ribbons

First through Fourth in Each Class

SATURDAY

Trick Dog Test

★ ★ ★ BRING YOUR OWN PROPS ★ ★ ★
Novice, Intermediate, Advanced and Performance levels

Canine Good Citizen and Canine Good Citizen Advanced

NOTE: For CGC, dogs do not need to be AKC registered;
mixed breeds are allowed.

Testing will be held from 1:00 p.m. - 4:00 p.m.
Every effort will be made to schedule the test around ring times.
Each dog passing the test will receive the
appropriate paperwork for certification.

Pre-Entry Fee: \$10.00 per dog ★ Day-of Fee: \$15.00 per dog
Pre-entries close Sunday, May 31st

REGISTRATION FORM

Check Box: Canine Good Citizen Trick Dog

Name _____

Address _____

City _____

State _____ Zip _____ Phone _____

Email _____

Dog's Name (as it should appear on certificate) _____

AKC/PAL# _____

Breed _____

Send entry and fee payable to: Mrs. Bonnie Craig
P.O. Box 635, Central Lake, MI 49622 -0112

Accommodations

Local motels that will accept dogs for our Show Weekend

Ask about restrictions, pet charges, etc.

Make Reservations ASAP – we are a Summer Resort Area.

Home2 Suites by Hilton.....	2684 N US 31 S, Traverse City MI 49684 • 231-401-1200
Tru by Hilton	3572 N US 31 S, Traverse City, MI 49684 • 844- 440-8389
Spark by Hilton.....	3701 N Country Dr, Traverse City, MI 49684 • 231-252-8638
Days Inn & Suites.....	1870 US 32 North, Traverse City, MI 49686 • 231-709-4989
Best Western Plus.....	305 Munson Ave (US 31), Traverse City, MI 49686 • 231-946-8424
Econo Lodge	1065 M-37, Traverse City, MI 49685 • 231-943-3040

TRAVERSE CITY AREA CAMPGROUNDS

Interlochen State Park	4167 J Maddy Pkwy, Interlochen, MI 49643 • 231-276-9511
Holiday Park Campground	4860 US 31 South, Traverse City, MI 49684 • 231-943-4410
Timber Ridge RV & Recreation Resort.....	4050 E Hammond Rd, Traverse City, MI 49686 • 231- 947-2770

THE GRAND TRAVERSE KENNEL CLUB WILL ENFORCE THE FOLLOWING: Any motel/hotel OR Camping area damage reported to and substantiated by the Event Committee will be dealt with by the Event Committee.

On-Site Camping – \$33 per night

Camping reservations are handled by the Northwestern Michigan Fairgrounds. Reservations will not be available until May 1, as the Fairgrounds is currently developing a new online reservation and payment system. The QR code links to their website, but reservation/ payment options will not be available until that date.



The site currently lists the standard rate of \$40/night. Use code **GTKennelclub** to receive the discounted rate of \$33/night. *Please be aware that we are unable to issue refunds or reimbursements for reservations made without the discount code.*

★ ★ ★ Thank you for your patience! ★ ★ ★

A Gate Pass (payable to GTKC) is required in addition to camping fees: \$10 per day or \$25 for a 3-day pass.

All campers must be placed on the outside circle of the grounds and in the regular camping area with electric and water. No campers will be allowed in the inner circle of the grounds. VEHICLES are limited to ONE per site and must abide by the 5 1/2 MPH speed limit in the campground. *Parking arrangements have been updated, so we kindly ask that you follow the instructions provided by the fairground personnel.*

You must clean up after your pet – IF YOUR DOG POOPS, PLEASE SCOOP!

NW Michigan Fairground Campground Amenities:

- 20, 30 & 50-amp power service • Potable water • Shuttle service to & from campground
- Bathrooms with showers (the sinks and showers are for human use only, not for bathing your dog)
- Sanitary dump station • \$20 dump station fee for non-campers

Please help our camping staff by leaving your campsite as you found it. Because the NWM Fairgrounds runs the camping, we will do our best to answer your questions and concerns. TEXT Sonya at 231-499-3043 or Tawnya Churchill at 810-853-2896 with any questions.

Routes to the Show

From North, South & East: M-37 to sign for fairground at W. Blair Townhall Road. Two (2) miles South of 31/37 Junction.

From West: M-31 to M-37 South, two (2) miles to sign for fairground at W. Blair Townhall Road. FOLLOW THE DOG SHOW SIGNS.

Site will be available at 11:00am on Thursday.

The site is closed one hour after Best in Show.

No dogs may be left unattended.

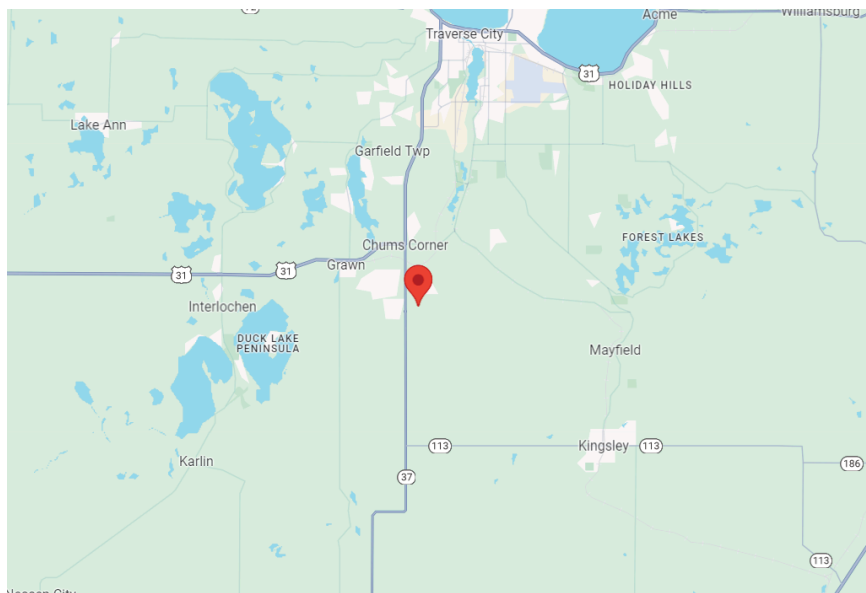

Gate Pass: \$10/day or \$25/3-day weekend





AMERICAN
KENNEL CLUB®

AKC® Code of Sportsmanship and Civility

Preface: The tradition of competitive purebred dog events predates 1884—the year the American Kennel Club (AKC®) was founded. Those involved in these sports share core values, including a strong commitment to sportsmanship and a welcoming, respectful culture that embraces the diverse community united by a love of dogs.

These values are evident across all aspects of the sport: conformation, performance, companion, and family dog activities. Many believe that the enduring principles of sportsmanship and civility are key reasons the sport has thrived for over 140 years.

Recognizing that periodically reaffirming our shared values strengthens our community, the revised code will be shared widely to highlight the foundational values and principles that define the sport.

- Sportspeople always place the welfare of their dog above all else.
- Sportspeople prioritize the long-term health and preservation of their breed, making decisions that reflect a deep commitment to responsible breeding and ownership.
- Sportspeople respect the history, traditions and integrity of the sport of purebred dogs.
- Sportspeople conduct themselves in a manner that reflects positively on the sport, the American Kennel Club, and themselves.
- Sportspeople appreciate, encourage and support all who associate with and participate in the sports by fostering an environment where respect, equity, inclusion, and courtesy are foundational.
- Sportspeople understand, uphold and abide by all AKC bylaws, rules, regulations and policies.
- Sportspeople contribute to a positive atmosphere at events by avoiding negative gossip, disparagement, or unsportsmanlike behavior.
- Sportspeople extend their values of civility, fairness, and respect to all digital and social media platforms.
- Sportspeople actively support the education and mentorship of newcomers, helping them learn the rules, values, and traditions of the sport in a respectful way.
- Sportspeople recognize that they are role models in the sport, and strive to lead by example through humility, kindness, and ethical conduct.
- Sportspeople treat fellow exhibitors, judges, officials, volunteers, spectators, and AKC staff with dignity and respect, regardless of experience, background, or differences in opinion.
- Sportspeople are committed to fair play, honesty, courtesy, and competition, approaching both winning and losing with grace.
- Sportspeople understand that strong competition and civility can—and should—coexist. They appreciate the quality of their competitors, and the effort put forth by others.
- Sportspeople uphold their responsibilities to the sport of purebred dogs and refuse to let personal gain or self-interest influence their decisions or behavior.
- The sportsperson judges only on the merits of the dogs and considers no other factors.
- The sportsperson judge or exhibitor accepts constructive criticism.
- The sportsperson exhibitor declines to enter or exhibit under a judge where it might reasonably appear that the judge's placements could be based on something other than the merits of the dogs.
- The sportsperson exhibitor refuses to compromise the impartiality of a judge.
- Sportspeople are willing to share honest and open appraisals of both the strengths and weaknesses of their breeding stock.
- Sportspeople decline to exploit any positions of authority or recognition for personal advantage.
- Sportspeople appreciate those that have gone before them and realize they are responsible for maintaining and enhancing the sport for future generations.



Everything We Do,
We Do for Dogs.

7/2025

Notice to Exhibitors

Telephone Entries and Unsigned Entries Cannot Be Accepted. Entries Not On Official AKC Entry Forms and Photocopies of Entry Forms without Agreement and Rules on the reverse side of the Official AKC Entry Form are **NOT ACCEPTABLE**.

Mail All Entries With Fees to Foy Trent Dog Shows, PO Box C, Sturgeon, MO. 65284.

Entries received without fees will not be accepted. Acknowledgement of entries will be made as soon as practicable after closing via mail or email. **Should acknowledgement not be received by the exhibitor** within a reasonable time. Please notify our office.

Special Delivery & Overnight Delivery Mailing Address:

Foy Trent Dog Shows LLC 113 W Smith St, Sturgeon, MO 65284

Online Entries accepted online at www.FoyTrentDogShows.com for entries made with MasterCard/Visa. A \$3.00 charge will be added to each entry.

No Faxed Entries Accepted

CANADIAN EXHIBITORS MUST SUBMIT ENTRIES WITH CHECKS DRAWN ON U.S. ACCOUNTS OR WITH INTERNATIONAL MONEY ORDERS IN U.S. FUNDS.

An AKC Event Fee of \$4.50 will be required for each entry in an event. There is no Event Fee for Junior Showmanship, Sweepstakes, Brace/Team, Multi-Dog Classes, or Special Attractions. A \$3.00 Event Fee will be required for each entry in 4-6 Month Beginner Puppy and each entry in FSS Open Shows. These Fees are paid to the American Kennel Club.

RETURNED CHECKS / INVALID CREDIT CARDS do not constitute a valid entry. The Superintendent will add a collection fee of \$25 to the amount of each returned check and credit card. Subsequent returned checks and credit card from the same exhibitors may result in their being put on a cash-only basis. Entry Fee will not be refunded in the event that a dog is absent, disqualified, excused by Veterinarian or judge, or barred from competition by action of the Show Committee.

No entry fees will be refunded if the Show cannot open or be completed by reason of riots, civil disturbances, fire, extreme and or dangerous weather conditions, an Act of God, public emergency, act of public enemy, strikes or any other cause beyond the control of the Club or the Superintendent.

No Refund for Duplicate Entries. Every effort to find all duplicate entries will be made; however, if entry has been processed, no refund will be made.

Refunds made for cancellation of entries before the closing date will be subject to a \$3.00 administrative/processing fee per entry.

No Entry shall be made and no entry shall be accepted which specifies any conditions as to its acceptance. Changes, additions or corrections to entry forms must be received in writing prior to close of entries. Those received by telephone are not acceptable.

To find out about any AKC event cancellations, call the AKC Event Cancellation Hotline 877-252-3229.

Dogs need be present only for scheduled judging and will be released if not needed for further judging. Dogs must be ready for judging. Neither the club nor the Superintendent will be responsible or obligated to furnish any service for notifying exhibitors or their agents of Breed or Class judging.

Judges need not wait for any dog holding up the class. **Owners or agents alone are responsible for the presence of their dogs in the judging rings.**

Exhibitors should follow their veterinarian's recommendation to assure their dogs are free of internal and external parasites, any communicable diseases and have appropriate vaccinations.

The show giving club, the Superintendent, their agents, employees, etc., assume no responsibility for any loss, damage, or injury sustained by exhibitors or handlers to any of their dogs or property, and further assume no responsibility for injury to children.

PUBLICATION RIGHTS By entering this show, all owners, handlers, breeders and kennels agree that all rights to televise, videotape, photograph, advertise, promote and publicize or otherwise exploit this show, or the persons or animals participating in it or the results of the competition before, during or after the event, shall belong solely to The American Kennel Club and their respective assigns, including the use of the names, likenesses or biographical matter of all dogs, owners, handlers, breeders and kennels participating in the show and no such owner, handler, breeder or kennel shall allow any other party to make commercial use of any videotape or photograph of any person or animal participating in this competition.

1/1/2026



OFFICIAL AMERICAN KENNEL CLUB ENTRY FORM

Friday, June 12, 2026 Show 1 [] Conf. #2026103415¹ [] Rally 1 #2026103417
Friday, June 12, 2026 Show 2 [] Conf. Jr Showmanship & NOHS #2026103416¹
[] Rally 2 #2026103418

Saturday, June 13, 2026 [] Conf., JSHW, Obed & Obed #2026103419 [] BPUP #2026103420
[] Rally #2026103430

Sunday, June 14, 2026 [] Conf., JSHW, Obed & Obed #2026103421
Entry limit 600

Northwestern Michigan Fairgrounds, 3606 Blair Townhall Rd., Traverse City, MI

ENTRIES OPEN 12 NOON SATURDAY, APRIL 25, 2026. Entries that are received prior to this date and time will be returned. ENTRIES CLOSE WEDNESDAY NOON, MAY 27, 2026, or when numerical limits have been reached, if reached before this date, at Foy Trent Dog Shows LLC.

Mail Entries with fees payable to Foy Trent Dog Shows LLC, PO Box C, Sturgeon, MO 65284
www.foytrentdogshows.com

1 ENCLOSE \$ for entry fees (See page 3 for entry fees)

IMPORTANT-Read Carefully Instructions on Reverse Side Before Filling Out. Numbers in the boxes indicate sections of the instructions relevant to the information needed in that box (PLEASE PRINT)

BREED VARIETY 1 SEX

DOG 2 3 SHOW CLASS CLASS 3 DIVISION Weight, color, etc.

ADDITIONAL CLASSES OBEDIENCE CLASS (Jump Height) RALLY CLASS (Jump Height) JR. SHOWMANSHIP CLASS

NAME OF (see Back) JUNIOR HANDLER (if any) JR. HANDLER NUMBER

FULL NAME OF DOG

Enter number here DATE OF BIRTH PLACE OF BIRTH (list country)

BREEDER

SIRE

DAM

ACTUAL OWNER(S) OWNER'S ADDRESS CITY STATE ZIP

NAME OF OWNER'S AGENT (IF ANY) AT THE SHOW Owner-Handled eligible? Yes No

I CERTIFY that I am the actual owner of the dog, or that I am the duly authorized agent of the actual owner whose name I have entered above. In consideration of the acceptance of this entry, I (we) agree to abide by the rules and regulations of The American Kennel Club in effect at the time of this event, and by any additional rules and regulations appearing in the premium list for this event, and further agree to be bound by the "Agreement" printed on the reverse side of this entry form. I (we) certify and represent that the dog entered is not a hazard to persons or other dogs. This entry is submitted for acceptance on the foregoing representation and Agreement. I (we) agree to conduct myself (ourselves) in accordance with all such Rules and Regulations (including all provisions applying to discipline) and to abide by any decisions made in accord with them.

SIGNATURE of owner or his agent duly authorized to make this entry

TELEPHONE# E-MAIL Address

Check this box if you would like to receive confirmation & judging program by postal mail instead of email.

E-MAIL Address (An acknowledgment or receipt of entry will be sent to the email address, postal mail by request)

Emergency Contact Telephone

AGREEMENT

I (we) agree that the club holding this event has the right to refuse this entry for cause which the club shall deem sufficient. In consideration of the acceptance of this entry and of the holding of this event and of the opportunity to have the dog judged and to win prizes, ribbons, or trophies, I (we) agree to hold the AKC, the event-giving club, their members, directors, governors, officers, agents, superintendents or event secretary and the owner and/or lessor of the premises and any provider of services that are necessary to hold this event and any employees or volunteers of the aforementioned parties, and any AKC approved judge, judging at this event, harmless from any claim for loss or injury which may be alleged to have been caused directly or indirectly to any person or thing by the act of this dog while in or about the event premises or grounds or near any entrance thereto, and I (we) personally assume all responsibility and liability for any such claim; and I (we) further agree to hold the aforementioned parties harmless from any claim for loss, injury or damage to this dog. Additionally, I (we) hereby assume the sole responsibility for and agree to indemnify, defend and save the aforementioned parties harmless from any and all loss and expense (including legal fees) by reason of the liability imposed by law upon any of the aforementioned parties for damage because of bodily injuries, including death at any time resulting therefrom, sustained by any person or persons, including myself (ourselves), or on account of damage to property, arising out of or in consequence of my (our) participation in this event, however such, injuries, death or property damage may be caused, and whether or not the same may have been caused or may be alleged to have been caused by the negligence of the aforementioned parties or any of their employees, agents, or any other persons. **I (WE) AGREE THAT ANY CAUSE OF ACTION, CONTROVERSY OR CLAIM ARISING OUT OF OR RELATED TO THE ENTRY, EXHIBITION OR ATTENDANCE AT THE EVENT BETWEEN THE AKC AND THE EVENT-GIVING CLUB (UNLESS OTHERWISE STATED IN ITS PREMIUM LIST) AND MYSELF (OURSELVES) OR AS TO THE CONSTRUCTION, INTERPRETATION AND EFFECT OF THIS AGREEMENT SHALL BE SETTLED BY ARBITRATION PURSUANT TO THE APPLICABLE RULES OF THE AMERICAN ARBITRATION ASSOCIATION. HOWEVER, PRIOR TO ARBITRATION ALL APPLICABLE AKC BYLAWS, RULES, REGULATIONS AND PROCEDURES MUST FIRST BE FOLLOWED AS SET FORTH IN THE AKC CHARTER AND BYLAWS, RULES, REGULATIONS, PUBLISHED POLICIES AND GUIDELINES.**

INSTRUCTIONS

1. (Variety) if you are entering a dog of breed in which there are varieties for show purposes, please designate the particular variety you are entering, i.e., Cocker Spaniel (solid color black, ASCOB, parti-color), Beagles (not exceeding 13 in., over 13 in. but not exceeding 15 in.), Dachshunds (longhaired, smooth, wirehaired), Collies (rough, smooth), Bull Terriers (colored, white), Manchester Terriers (standard, toy), Chihuahuas (smooth coat, long coat), English Toy Spaniels (King Charles and Ruby, Blenheim and Prince Charles), Poodles (toy, miniature, standard).
2. The following categories of dogs may be entered and shown in Best of Breed competition: Dogs that are Champions of Record and dogs which, according to their owners' records, have completed the requirements for a championship, but whose championships are unconfirmed. The showing of unconfirmed Champions in Best of Breed competition is limited to a period of 90 days from the date of the show where the dog completed the requirements for a championship.
3. (Event Class) Consult the classification in this premium list. If the event class in which you are entering your dog is divided, then, in addition to designating the class, specify the particular division of the class in which you are entering your dog, i.e., age division, color division, weight division.
4. A dog must be entered in the name of the person who actually owned it at the time entries for an event closed. If a registered dog has been acquired by a new owner it must be entered in the name of its new owner in any event for which entries closed after the date of acquirement, regardless of whether the new owner has received the registration certificate indicating that the dog is recorded in his name. State on entry form whether transfer application has been mailed to the AKC. (For complete rules, refer to Chapter 11, Section 3.)
5. Mixed Breed dogs entering classes for Agility, Obedience, and Rally trials should mark Breed as AKC Canine Partners Listed Dog "All American Dog/Mixed Breed." Variety, Breeder, Sire, Dam information shall remain blank for mixed breed entrants.

If this entry is for Junior Showmanship, please give the following information:

JUNIOR SHOWMANSHIP JR.'S DATE OF BIRTH _____

AKC JUNIOR HANDLER NUMBER _____

The above number MUST be included. Should you not have your Junior Handler number, this may be obtained from the American Kennel Club. Phone: (919) 233-9767.

By signing the entry form I (we) certify that the Junior Showman does not now, and will not at any time, act as an agent/handler for pay while continuing to compete in Junior Showmanship.

ADDRESS _____

CITY _____ STATE _____ ZIP _____

■ If Junior Handler is not the owner of the dog identified on the face of this form, what is the relationship of the Junior Handler to the Owner?